

DA

DA SERIES FULL CONE SPRAY NOZZLE (PLASTIC VERSION)

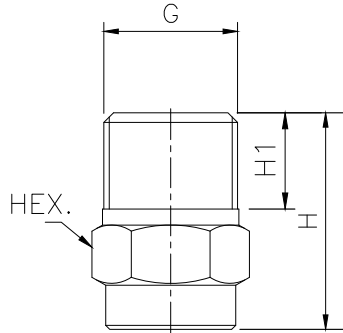

DA series Full Cone Spray Nozzle form complete spray coverage in a round area. It provides an uniform spray distribution of medium to large size drops resulting from their vane design which features large flow passage and control characteristics.

MODEL NO.	END CONNECTION		ORIFICE SIZE (mm)	FLOW CAPACITY IN LPM AT DIFFERENT PRESSURE							G/A DIMENSION. MM			
	1/4"	3/8"		PRESSURE [BAR]										
SPRAY ANGLE	BSP	BSP												
45°				0.5	1.0	2.0	3.0	5.0	7.0	10.0	CONN.	H	H1	HEX
DA13.250	•		1.9	1.25	1.77	2.50	3.06	3.95	4.68	5.59	1/4"	25	9.7	15.5
DA13.300	•		2.0	1.50	2.12	3.00	3.67	4.74	5.61	6.71	Weight = XX gms. Approx			
DA13.350	•	•	2.2	1.75	2.47	3.50	4.29	5.53	6.55	7.83	3/8"	27	12	17
DA13.400	•	•	2.4	2.00	2.83	4.00	4.90	6.32	7.48	8.94	Weight = XX gms. Approx			
DA13.475	•	•	2.6	2.37	3.36	4.75	5.82	7.51	8.89	10.62				
DA13.650		•	3.1	3.25	4.60	6.50	7.96	10.28	12.16	14.53				

MODEL NO.	END CONNECTION		ORIFICE SIZE (mm)	FLOW CAPACITY IN LPM AT DIFFERENT PRESSURE							G/A DIMENSION. MM			
	1/4"	3/8"		PRESSURE [BAR]										
SPRAY ANGLE	BSP	BSP												
60°				0.5	1.0	2.0	3.0	5.0	7.0	10.0	CONN.	H	H1	HEX
DA14.350	•		2.2	1.75	2.47	3.50	4.29	5.53	6.55	7.83	1/4"	25	9.7	15.5
DA14.400	•	•	2.4	2.00	2.83	4.00	4.90	6.32	7.48	8.94	Weight = XX gms. Approx			
DA14.475	•	•	2.6	2.37	3.36	4.75	5.82	7.51	8.89	10.62	3/8"	27	12	17
DA14.650	•	•	3.1	3.25	4.60	6.50	7.96	10.28	12.16	14.53	Weight = XX gms. Approx			
DA14.800		•	3.4	4.00	5.66	8.00	9.80	12.65	14.97	17.89				
DA24.100		•	3.8	5.00	7.07	10.0	12.25	15.81	18.71	22.36				

MODEL NO.	END CONNECTION		ORIFICE SIZE (mm)	FLOW CAPACITY IN LPM AT DIFFERENT PRESSURE							G/A DIMENSION. MM			
	1/4"	3/8"		PRESSURE [BAR]										
SPRAY ANGLE	BSP	BSP												
90°				0.5	1.0	2.0	3.0	5.0	7.0	10.0	CONN.	H	H1	HEX
DA16.350	•	•	2.2	1.75	2.47	3.50	4.29	5.53	6.55	7.83	1/4"	25	9.7	15.5
DA16.400	•	•	2.3	2.00	2.83	4.00	4.90	6.32	7.48	8.94	Weight = XX gms. Approx			
DA16.475	•	•	2.5	2.37	3.36	4.75	5.82	7.51	8.89	10.62	3/8"	27	12	17
DA16.650	•	•	2.9	3.25	4.60	6.50	7.96	10.28	12.16	14.53	Weight = XX gms. Approx			
DA16.800	•	•	3.3	4.00	5.66	8.00	9.80	12.65	14.97	17.89				
DA26.100		•	3.6	5.00	7.07	10.00	12.25	15.81	18.71	22.36				
DA26.125		•	4.1	6.25	8.84	12.50	15.31	19.76	23.39	27.95				
DA26.160		•	4.6	8.00	11.31	16.00	19.60	25.30	29.93	35.78				

MODEL NO.	END CONNECTION		ORIFICE SIZE (mm)	FLOW CAPACITY IN LPM AT DIFFERENT PRESSURE							G/A DIMENSION. MM			
	1/4"	3/8"		PRESSURE [BAR]										
SPRAY ANGLE	BSP	BSP												
120°				0.5	1.0	2.0	3.0	5.0	7.0	10.0	CONN.	H	H1	HEX
DA18.400	•	•	2.5	2.00	2.83	4.00	4.90	6.32	7.48	8.94	1/4"	25	9.7	15.5
DA18.475	•	•	2.7	2.37	2.36	4.75	5.82	7.51	8.89	10.62	Weight = XX gms. Approx			
DA18.650	•	•	3.1	3.25	4.60	6.50	7.96	10.28	12.16	14.53	3/8"	27	12	17
DA18.800	•	•	3.5	4.00	5.66	8.00	9.80	12.65	14.97	17.89	Weight = XX gms. Approx			
DA28.100		•	3.9	5.00	7.07	10.00	12.25	15.81	18.71	22.36				
DA28.125		•	4.3	6.25	8.84	12.50	15.31	19.76	23.39	27.95				
DA28.160		•	4.9	8.00	11.31	16.00	19.60	25.30	29.93	35.78				